

HEART OF  
HOLBECK  
VISION

# CONTENTS

## 1. Introduction

- 1.1 The LUF project
- 1.2 Planning context

## 2. Understanding Holbeck

- 2.1 Collared
- 2.2 A place that others drive through and fragment
- 2.3 Thriving central park
- 2.4 Historic streets
- 2.5 Part of an emerging active travel network

## 3. A vision for Holbeck

## 4. Strategic principles

- 4.1 A place for the people
- 4.2 A connected slow route through
- 4.3 An inclusive park + network of pocket parks

## 5. Masterplan

- 5.1 Overview of projects
- 5.2 Domestic St and St Matthew's St
- 5.3 Holbeck Centre and Top Moor Side
- 5.4 Holbeck Moor Park
- 5.5 Brown Lane East and Ingram Road
- 5.6 St Matthew's Park
- 5.7 Pocket Parks
- 5.8 Stocks Hill and Bridge Road
- 5.9 Recreations Group Repair

## 6. Next steps

### Appendix A - Schedule of Projects

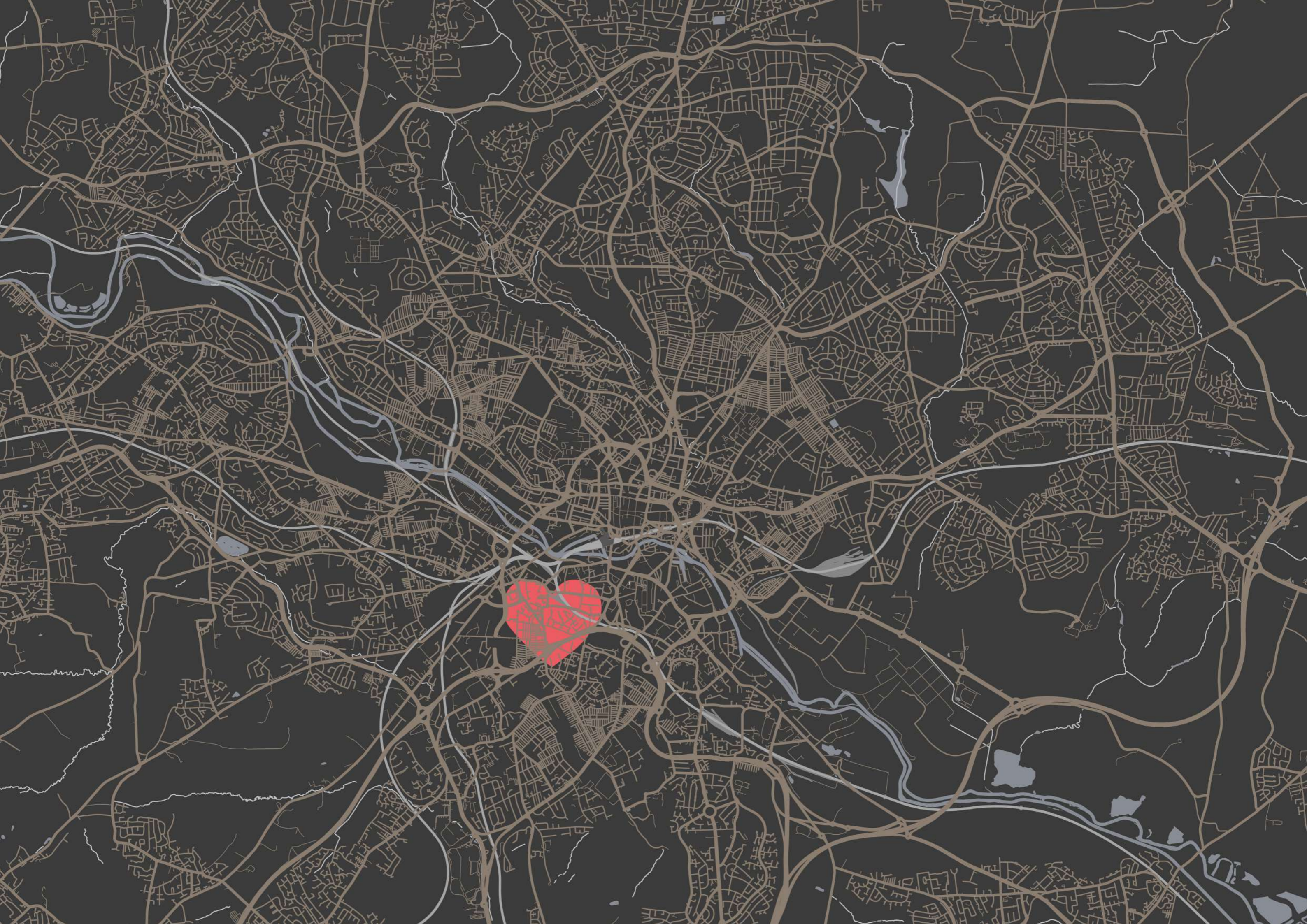

# 1.1 The LUF Project

The 'Heart of Holbeck' plans will deliver transformative change through the renewal of the local high street, transformation of the local community centre and the delivery of improvements to traditional terraced homes.

There are three strands that formed the successful bid for £15.9m from the government's Levelling Up Fund (LUF).

- The work of local charity, Holbeck Together will be supported through improvements to St Matthew's Community Centre where it currently delivers its vital services, and an expansion into the adjoining Old Box Office in partnership with current owner, Leeds Building Society. The regeneration of both sites is set to enable a wide range of new services to be offered.
- Significant investment into the public realm and local environment, uplifting the appearance, functionality, safety and accessibility of public spaces across central Holbeck. This includes significant investment into local retail centre, cycle and pedestrian infrastructure and renewal of the main community park, Holbeck Moor.
- The investment will also help improve housing conditions for around 200 back-to-back homes, addressing their insulation, safety and external appearance, securing financial contributions from landlords to upgrade some of worst private sector housing conditions in Leeds.

Local people have played a key role in defining the future of Holbeck, not least through the Holbeck Neighbourhood Plan (HNP) which covers the period 2017 to 2028 and enables the community of Holbeck to shape the development and growth of the local area through a shared vision for the neighbourhood.

This spatial framework sets out how the LUF investment will deliver some of the key outcomes of the HNP, and identifies future opportunities for open space and street improvements, to be considered by the community.



Holbeck Together will be able to extend the valuable support it provides local people and be come easier to access



Investment in Holbeck Moor Park will improve existing facilities and ensure the space is more inclusive



Changes to Domestic Street, St Matthew's Street and Top Moor Side, will support local retailers, improve pedestrian access and reduce the negative effects of through traffic

# 1.2 Planning context

The Heart of Holbeck project has developed directly from the policies and vision set out in the Holbeck Neighbourhood Plan. This document was produced with the community to help them guide new development and improve their spaces and streets.

Positive change in Holbeck is part of Leeds' ambition to be a more inclusive and connected place. Centred on a pre-industrial village, Holbeck is an inner-city area located about 1km from Leeds' thriving city centre. The southward expansion of the city centre is gaining momentum but there is still significant severance caused by established use of the highway network and low quality streetscapes that separate the community from employment, education, services and transport connections in the city centre.

Leeds Best City Ambition sets out three pillars - Health and Wellbeing, Inclusive Growth and Zero Carbon - that will benefit those residents who are most in need. In addition it sets out an approach of working together, shifting power to citizens, and drawing on the support of businesses and public institutions.

Heart of Holbeck will improve the experience of travelling toward jobs in the city centre, re-allocating vehicle space for better walking and cycling opportunities while supporting local people to live healthy and active lives, through improvements to Holbeck Moor Park and other green spaces.

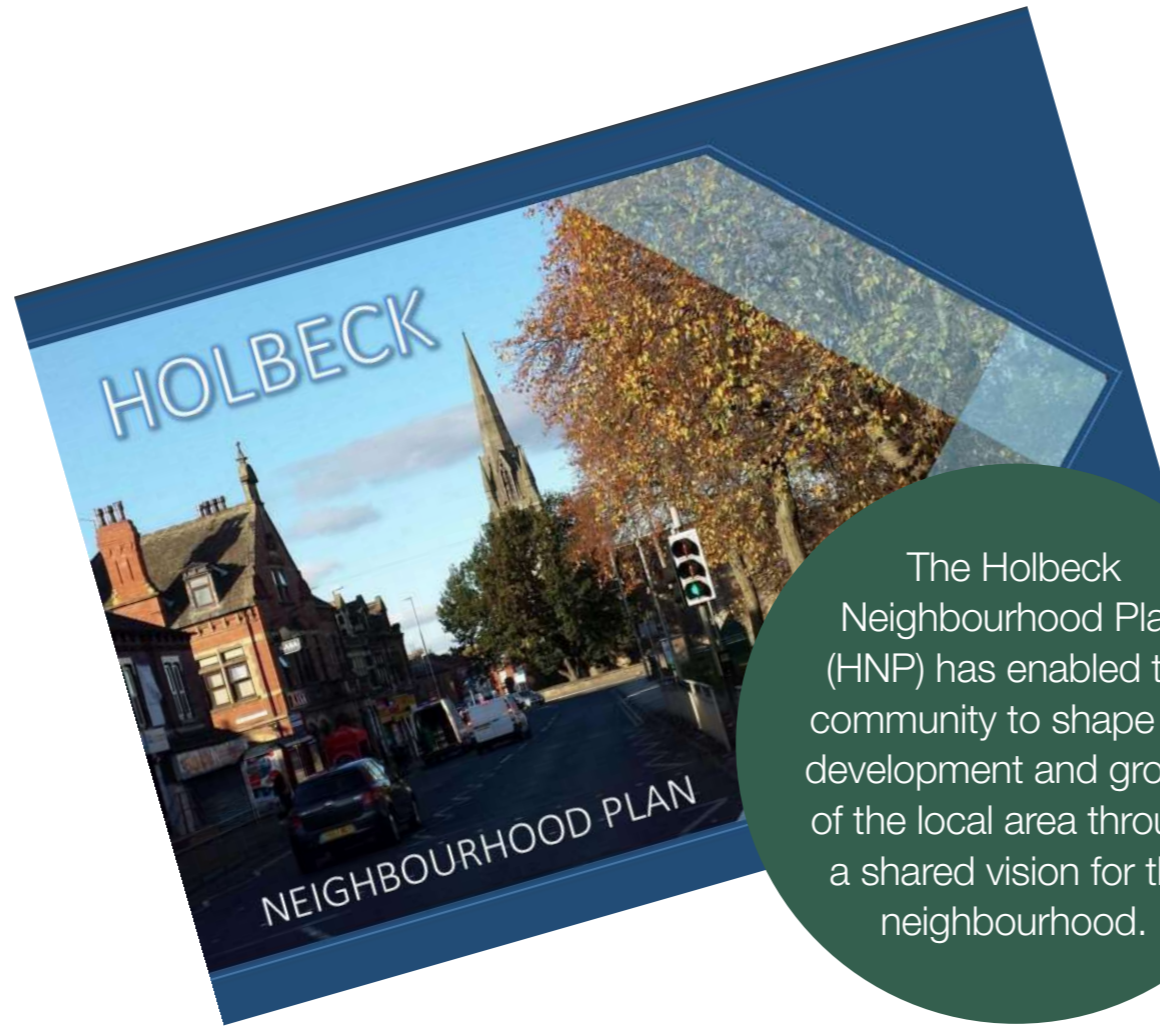

The Holbeck Neighbourhood Plan (HNP) has enabled the community to shape the development and growth of the local area through a shared vision for the neighbourhood.



Holbeck is one of the Key Neighbourhoods identified in the recently published 'A Vision for Leeds', identifying Heart of Holbeck



Leeds Inclusive Growth Strategy will tackle inequality, making Leeds an attractive place for businesses while creating a transport system that means you don't need a car

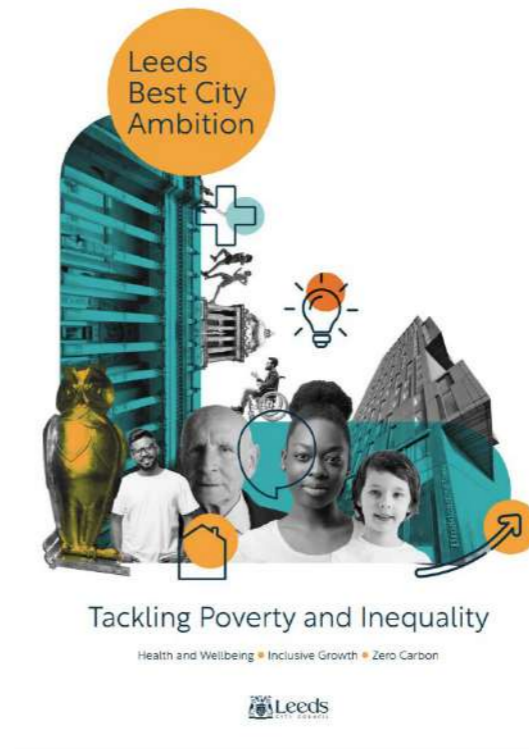

Heart of Holbeck will supports the three pillars of Leeds' Best City Ambition - Health and Wellbeing, Inclusive Growth and Zero Carbon.

# UNDERSTANDING HOLBECK

## 2.1 Collared

- The road network around Leeds City Centre creates a barrier to movement, particularly between the suburbs and the city centre.
- Both the M621 and the A643 are busy commuter routes which cut through Holbeck. Additionally, a number of smaller roads within Holbeck are used as through routes between the M621 and the city centre.
- The railway line at the eastern edge of Holbeck prevents easy movement between Holbeck and the city centre.
- Despite its proximity, Holbeck is fragmented and severed from the city centre.
- There is a key opportunity to improve Holbeck's connectivity to the city centre and reduce the impact of the road and rail



Holbeck is bounded to the south by the M621



Elevated railway viaducts separate the city centre from Holbeck

## 2.2 A place that others drive through and fragment

- Holbeck has a number of main roads running through its centre, some of which are used as commuter routes between the M621 and the city centre.
- Few of the car users stop in Holbeck, using the route as a means to reduce their journey time.
- The roads running N-S through Holbeck create a barrier to movement between the residential area to the east and Holbeck Moor Park to the west.
- Holbeck Together and St Matthews Community Centre are at the heart of the Holbeck community. However, they are located on a busy junction with little outside space.

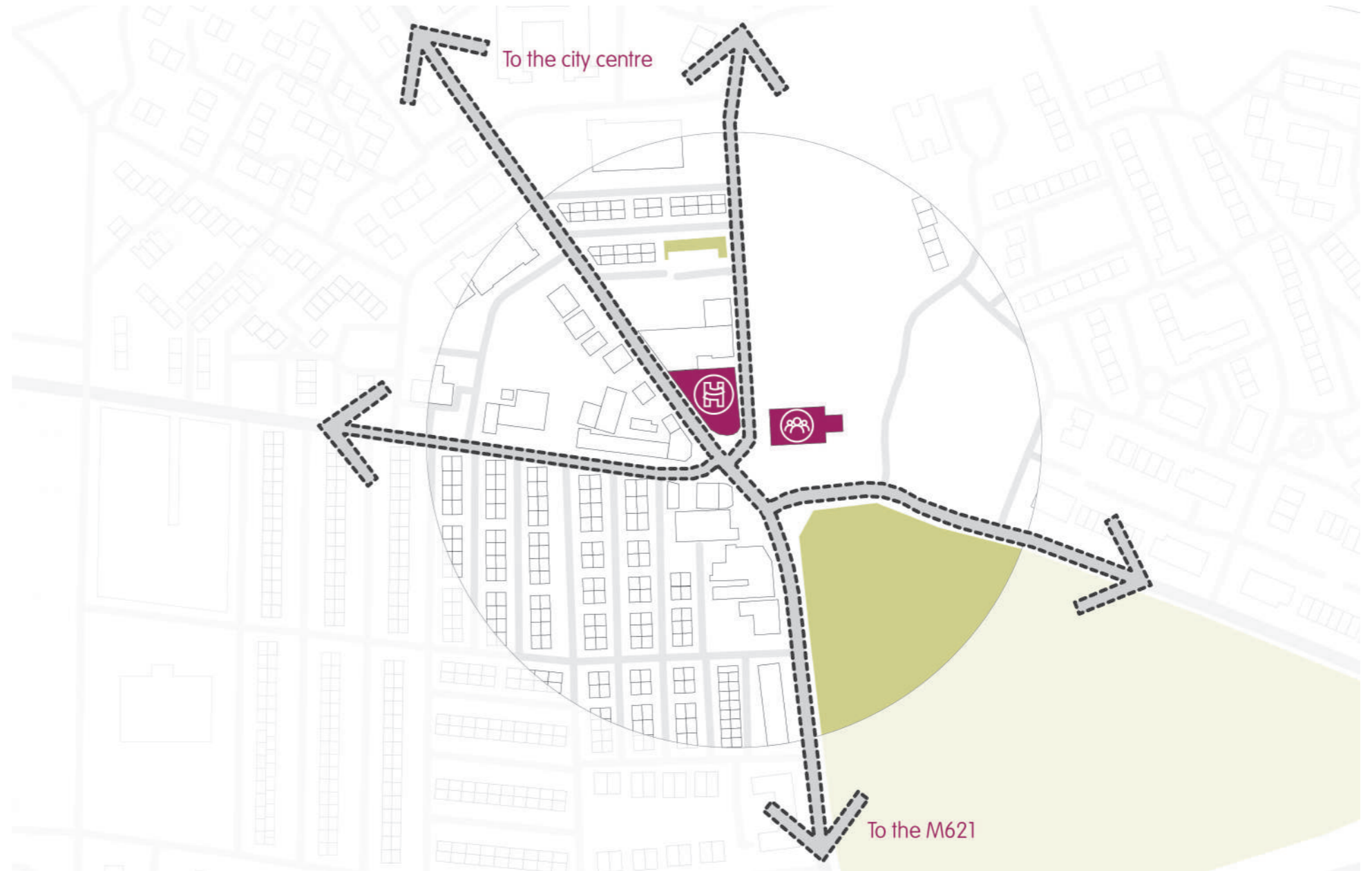

Multiple streets converge on the area around St Matthew's Church, creating an environment dominated by vehicles, making it unattractive and uninviting for pedestrians - Domestic Street, junction with Top Moor Side and Meynell Approach





## 2.3 Thriving central park

- Holbeck Moor Park contains a number of well used facilities: skate park, basketball court, football pitch and play area.
- Strava data indicates that the park is consistently well used for running and walking. Of these records, 72% were recorded as leisure and 28% as commute.
- The park and its facilities have become dilapidated in places and are in need of re-consideration and development.

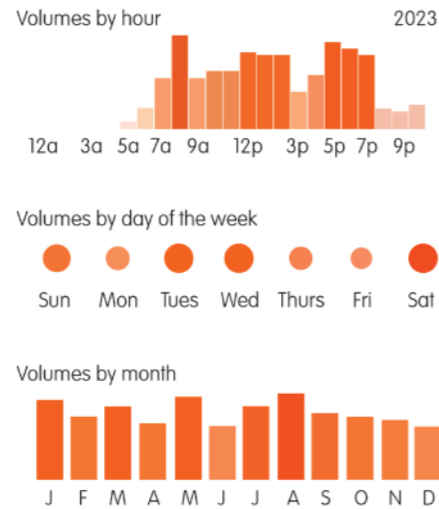

### KEY FEEDBACK FROM 2022 SURVEY

#### Top 5 likes:

- Green space
- Equipment / facilities
- Trees / flowers
- Pleasant space
- Sessions on the moor
- Close to the city centre

#### Top 5 requested improvements:

- More trees, planters, flowers
- Increased seating
- Less litter
- Improvements to the playground
- More community events



An important place for informal recreation, with mature trees



The play area and MUGA are well located centrally but could be more inclusive



The skate park is extremely popular but showing signs of wear and tear

## 2.4 Historic streets

- There is a large area of back to back houses to the west of Holbeck Moor Park. They once housed workers for nearby foundries and mills.
- Holbeck contains a number of Grade II listed buildings including the Church of St Matthew, St Edward's Vicarage and Holbeck Mills Carpet Warehouse.
- The Holbeck Neighbourhood Plan proposes improvements to the Housing Heritage Area.
- The Battle of Holbeck Moor was a clash between the British Union of Fascists and various anti-fascist demonstrators that took place in the modern day Holbeck Moor Park on 27 September 1936 (see images below).



There are several listed buildings in Holbeck which have a dominant presence on the street, Holbeck Mill and St Matthew's Church can become important community locations. Holbeck Moor has always been a significant part of the Holbeck community with a long history of supporting community cohesion and inclusivity

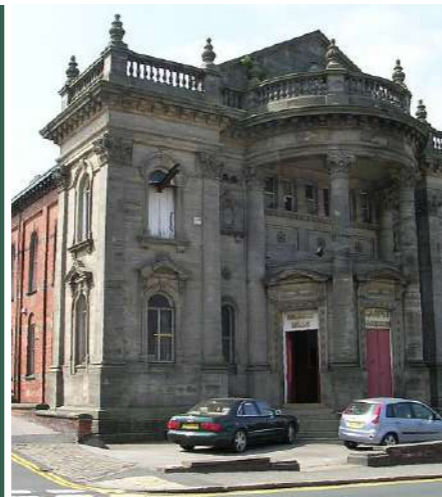

## 2.5 Part of an emerging active travel network

- There are a number of existing segregated cycle routes between the city centre and south Leeds delivered as part of around £2.5m investment into cycle superhighway standard infrastructure.
- Leeds City Council has an ambition for a comprehensive sustainable travel network linking the city centre to south Leeds.
- There is a great opportunity to link Holbeck to this active travel network, and improve its connection to the city centre.

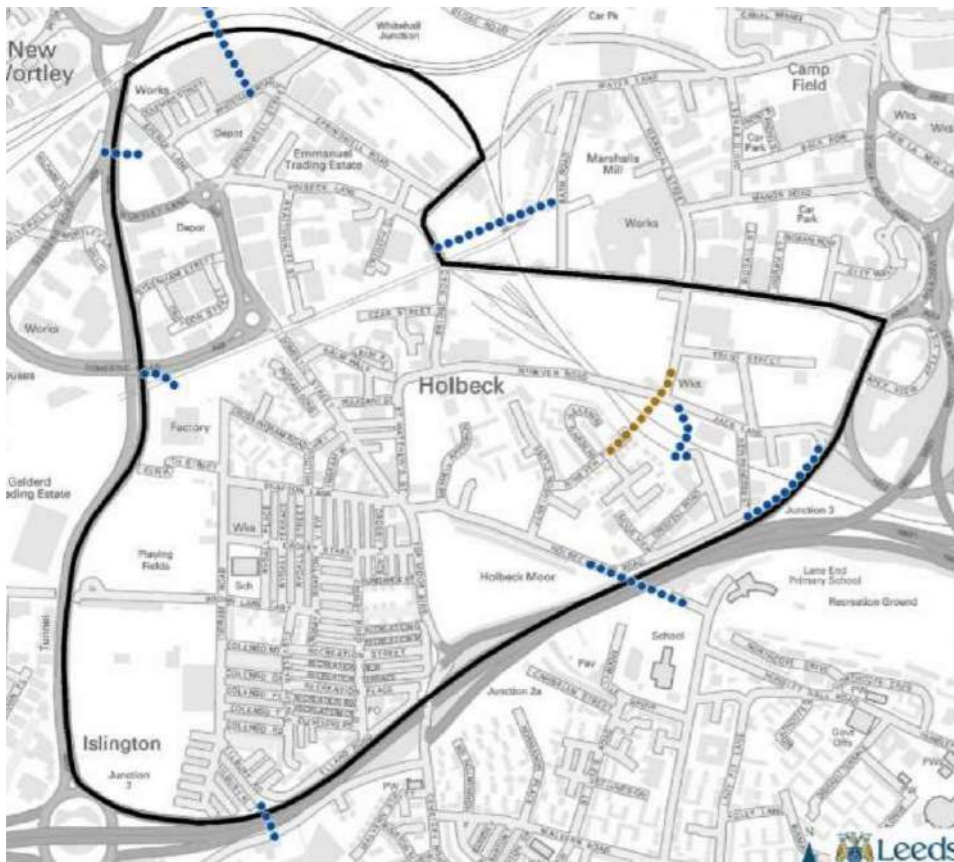

Potential opportunities for new walking and cycling routes in the HNP

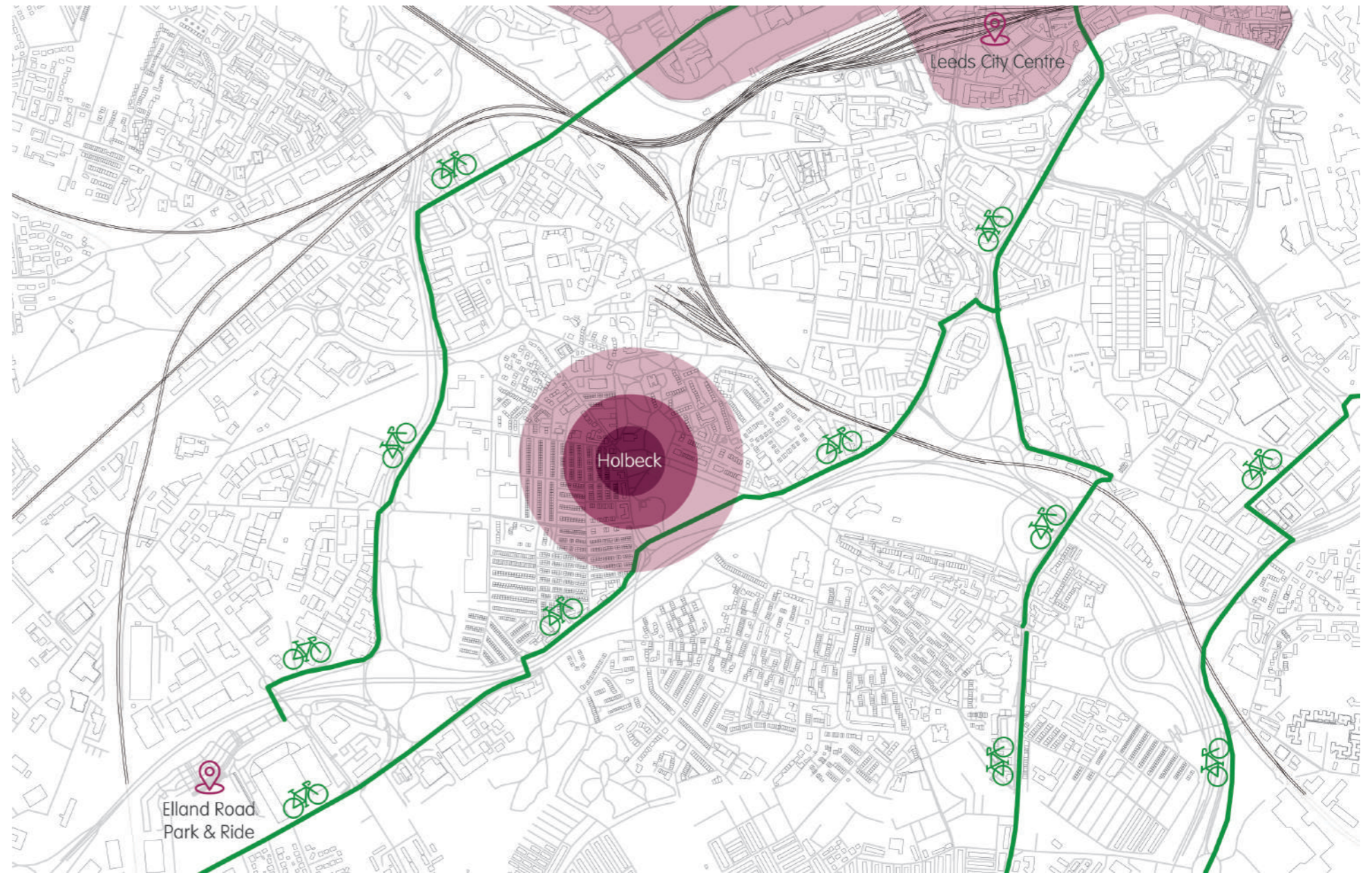

The Elland Road City Connect cycle route, runs through Holbeck Moor Park, connecting people to the city centre. There are plans to extend this network to benefit local communities



## 2.6 The spire in the centre

- › The spire of St Matthew's Community Centre is visible across much of Holbeck. It terminates many key views and helps with way-finding across the area.
- › The building creates a distinct sense of place and arrival and, combined with Holbeck Together, is the centre of the community.
- › The building helps to tell the story of the heritage of the area and as such it should be preserved and celebrated.



Key Views

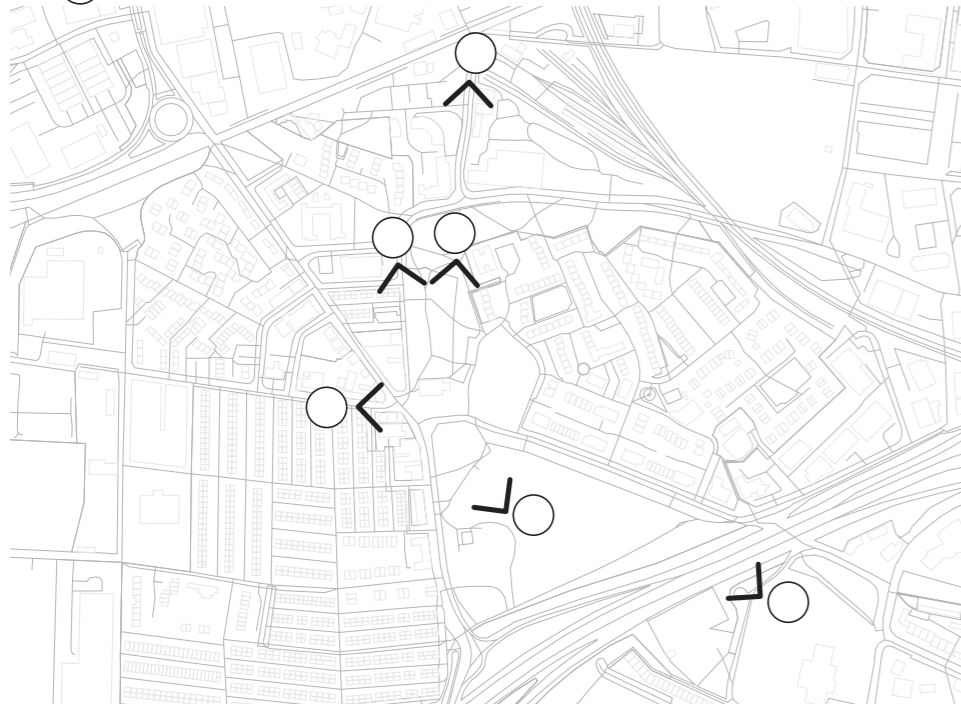

# A VISION FOR HOLBECK

### 3.0 A Vision for Holbeck

- › The community has defined its own ambitions for the future of Holbeck in the Holbeck Neighbourhood Plan.
- › Many of the policies and initiatives in the HNP are reflected in this document and will partly be delivered through the LUF 3 programme
- › The vision can be articulated in three pillars

A DISTINCTIVE PLACE WITH A  
**STRONG**  
COMMUNITY  
WHERE PEOPLE ARE  
PROUD TO LIVE

A CONNECTED  
PLACE THAT ALLOWS  
PEOPLE TO TRAVEL  
HEALTHILY AND  
SAFELY  
TO LEARN, WORK, SHOP AND PLAY

AN INCLUSIVE PLACE, THAT  
**REPRESENTS**  
AND  
**SUPPORTS**  
HOLBECK'S DIVERSE POPULATION



# STRATEGIC PRINCIPLES

## 4.1 A place for the people

- Changes to Domestic Street, Top Moor Side and St Matthew's Street will slow vehicles and reduce the impact of traffic, creating more space for safe pedestrian movement
- Spaces will be designed for walking, encouraging more freedom for people and a more attractive centre
- The Holbeck Neighbourhood Plan recognises this area as a focal point for heritage and the community
- Holbeck Together and St Matthew's Community Centre will have an improved setting with better access and more space to extend their offer outside
- Highway space will be reallocated to support local businesses and attract new retailers by creating opportunities to 'stop and shop'





## 4.2 A connected, attractive route through

- Two direct, high quality cycle routes have been delivered, linking Elland Road and the South Leeds Growth Corridor with the city centre
- A new, connected, attractive route, enabling people to stop in the transformed centre, using green spaces to link with Water Lane and South Bank
- This route will be multi-functional, allowing people to stop and use the shops, play in the park or visit the community centre
- Green infrastructure will frame this route, using existing green space, new planting and transformed streets, to create a direct route through
- The Holbeck Neighbourhood Plan proposes a Heritage Trail that follows the same line and will add a layer of richness to the route

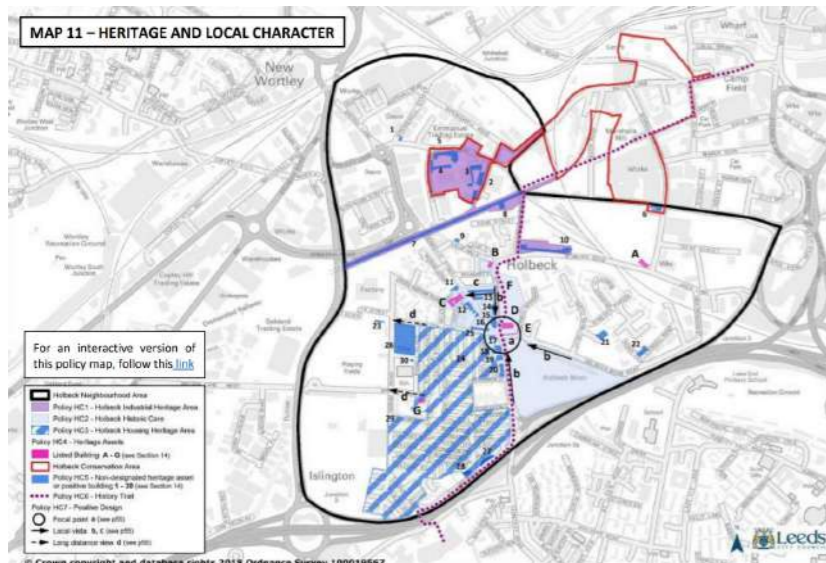
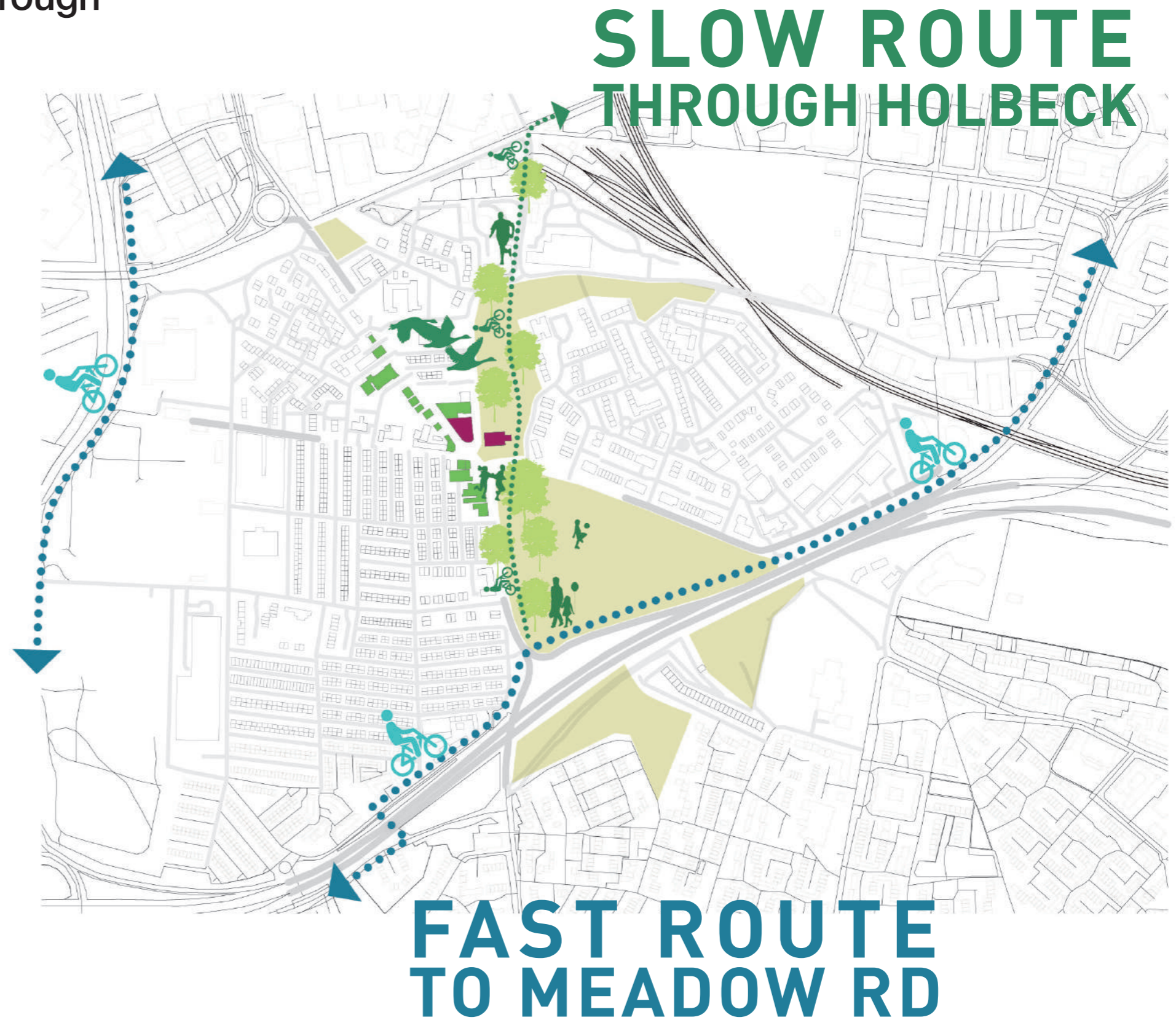

## 4.3 An accessible inclusive park + pocket park network

- Holbeck Moor Park has historic significance and is a vital part of the community, but local people want it to do more
- The park will be improved to make it more attractive for those not currently using the park, and addressing barriers to people using the space
- There will be easier access to the park, with more entry points and easier routes across the boundary roads
- The aim is to form better links with St Matthews Community Centre, through provision of improved access, better use of highway space and improved public realm
- The Church Yard will become an active community space, extending along Nineveh Road to create a space that meets the needs of the local community
- Existing pocket spaces around the community have the potential to improve in the future to offer better quality 'door step' amenity for residents
- Green links - through new planting and re-modelled streets will better connect surrounding spaces with Holbeck Moor Park



**A PARKLAND ENVIRONMENT  
CONNECTING  
TWO SIDES OF HOLBECK**

# MASTERPLAN

# 5.0 The Outline Masterplan



- 1 Holbeck Moor Park - an inclusive, multi-functional space for the community
- 2 St Matthew's Community Centre environs - an attractive, pedestrian priority space at the centre of Holbeck
- 3 A new one-way gyratory system around the local centre
- 4 Transformed Brown Lane East, connecting Holbeck Moor Park with the new Sports Hub
- 5 A potential new linear park, shaped by the community combining the church yard with the swathe of green space on Nineveh Road
- 6 Potential pocket parks could be considered across Holbeck
- 7 Improved space and access on the southern side of Holbeck Moor Park
- 8 Parkland space delivered as part of the Holbeck Sports Hub on the Matthew Murray Site
- 9 Potential new pedestrian access to Shafton Lane Allotments to improve community benefits and create a strong link with Sports

# 5.1 Overview of projects

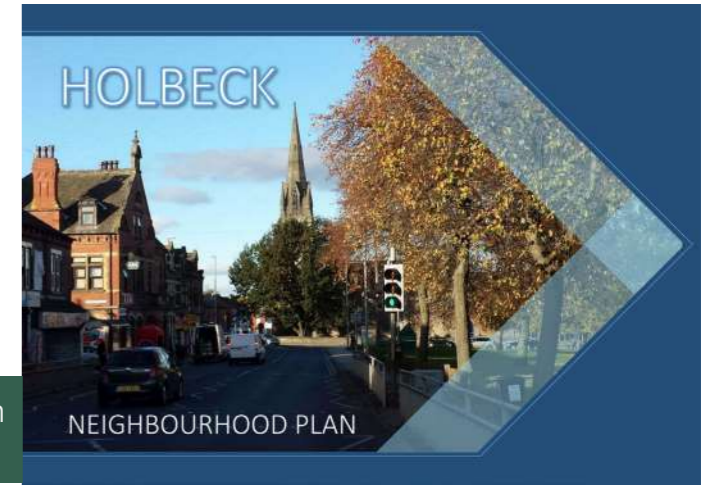

The Holbeck Neighbourhood Plan has established the intention for many of the projects identified below

· Within the outline masterplan a series of projects have been identified and are described in more detail on the following pages.

- 5.2** Domestic St and St Matthew's St
  - One-way vehicle movement, unlocking space along main local street
  - Wider footpaths, new street trees with more space and a better setting for retailers
- 5.3a** Holbeck Centre - St Matthew's Community Centre
  - The refurbishment of St Matthew's Community Centre and extension of the old Box Office will create a substantial community anchor
- 5.3b** Holbeck Centre - Public Realm
  - The junction will become a space that prioritises people and a clearer, safer environment
- 5.4** Holbeck Moor Park
  - Multi-functional local park that will support play, exercise and community events
  - A new framework of paths and access points, creating easier and more inclusive access
- 5.5** Brown Lane East & Ingram Road
  - A re-modelled active travel street that connects Holbeck Moor Park with the Sports Hub
  - Wider footpaths, street trees and protected cycle ways and potential to consider the re-routing of traffic to create a one-way loop around the Recreations
- 5.6** St Matthew's Park
  - Create a linear park combining the church yard and swathe of green space to the south of Nineveh Road
  - Doorstep facilities for residents and an attractive strategic active travel route
- 5.7** Pocket Parks
  - A programme of working with residents to adapt their local spaces and encourage long term stewardship
  - Ideas around play, food growing, new habitats and social space can be explored
- 5.8** Stocks Hill and Bridge Road
  - An important linking street between St Matthew's Park and Water Lane
  - The street will maintain 2-way vehicle movement but with a narrowed carriageway to improve the pedestrian experience
- 5.9** Recreations Group Repair
  - Phase 3 of the Holbeck Group Repair retrofit scheme
  - Will include external wall insulation process to meet the PAS2035 specification
  - Measures will ensure there are no cold spots to the insulation, and include work around window/door openings and at eaves level of the roof minimum below DPC level etc.



**0.0** numbers were part of the LUF bid are planned for delivery

**0.0** numbers are currently un-funded but will support the long term regeneration of Holbeck

## 5.2 Domestic St and St Matthew's St

- Movement along these two streets will be re-organised to provide a one-way gyratory system
- Creating a modal filter at the end of Shafton Lane will also help to simplify the junction, prioritising pedestrian movement.
- The narrow carriageway will allow space to be relocated for wider footpaths and green infrastructure
- There is an opportunity to use some of this infrastructure for managing service water, as well as forming an important connecting nature corridor away from Holbeck Moor Park
- Wider footpaths will also allow space for retailers to occupy the public realm, whilst providing a more attractive setting for businesses
- Footpaths will be concrete flag paved to create a smooth, quality surface that is easy to maintain.



More space for people - to walk through and occupy the space

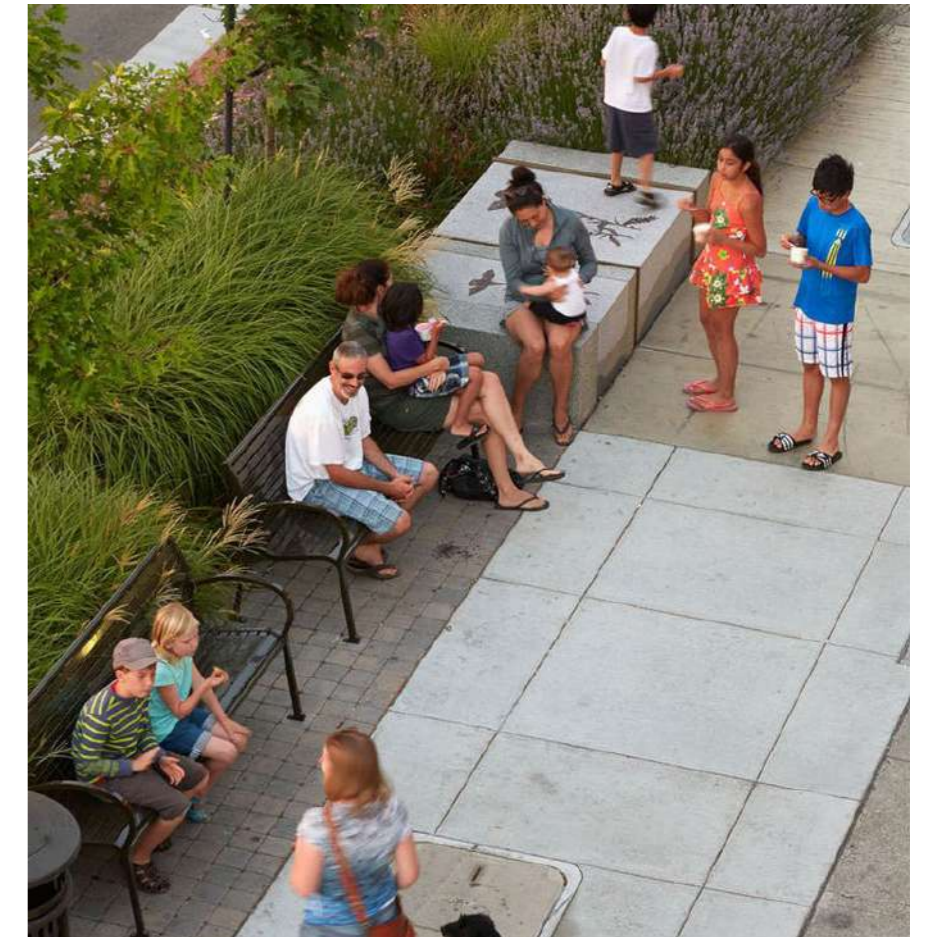

Street trees, and potentially, lower level planting to add colour, provide protection and support nature



## 5.2 Domestic St and St Matthew's St

### Materials, planting and furniture



Street trees and possible rain gardens



Coloured SMA - clear crossings



LCC Highways paving specification



Social seating in small clusters

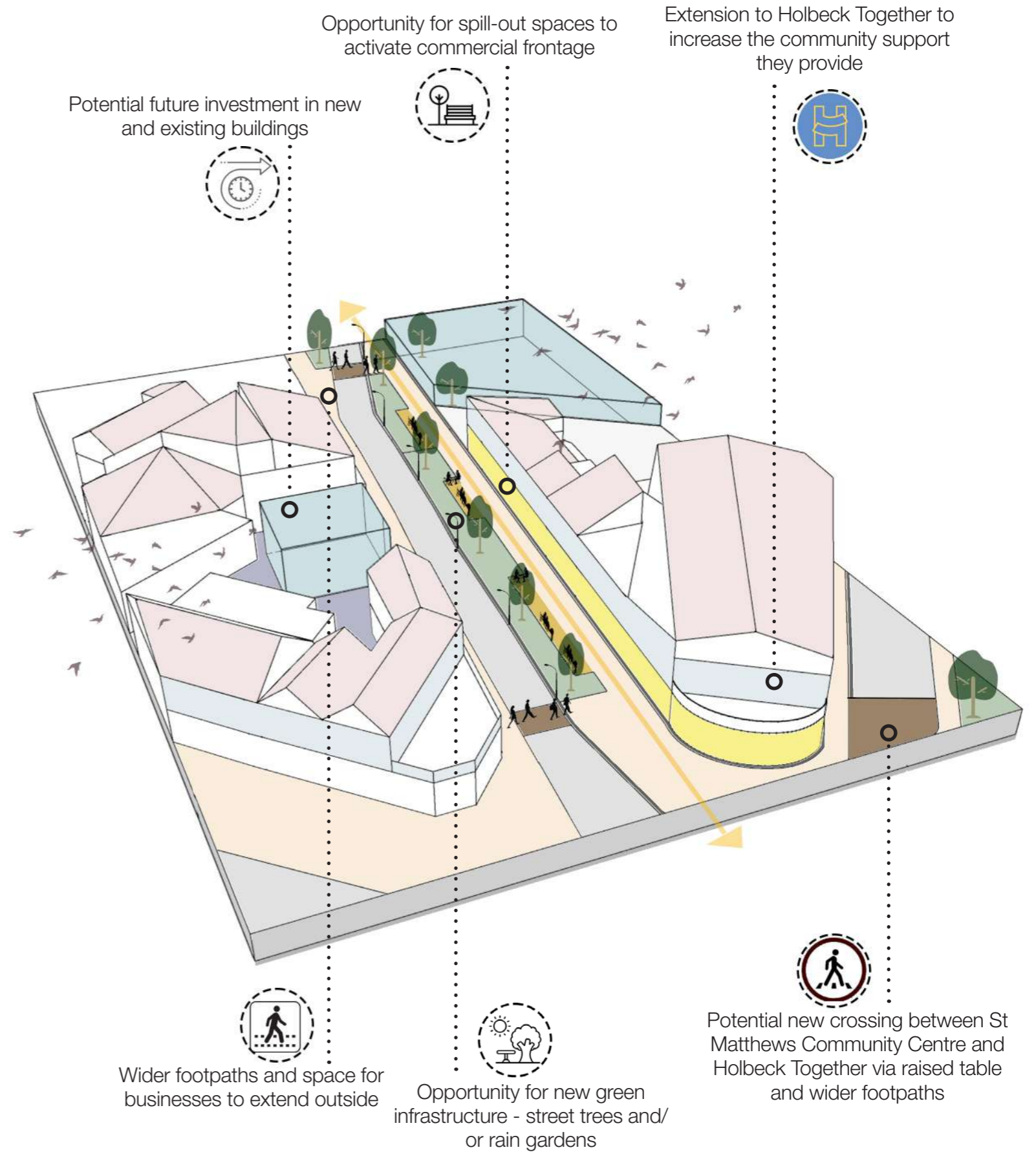

## 5.3 Holbeck Centre and Top Moor Side

- The junction of Domestic Street and Top Moor Side now has the opportunity to be remodelled to provide a high-quality pedestrian environment
- The narrow, carriageway and tighter, turning movement will create more space and slow vehicle speeds, allowing easier, and safer movement between Holbeck, Moor Park, St Matthews Community Centre, Holbeck Together, and the recreations housing area
- This environment will become the centre of gravity for Holbeck, and a distinctive marker for those passing through
- Car parking to support local businesses will be provided away from the centre but close enough to be convenient.
- There is an opportunity, if budgets allow, to use local Yorkstone Paving around the listed community centre, which also establishes this central area, at the top of the hierarchy of streets and spaces
- Parking will remain available close to Holbeck Centre



Tighter junction, roundabout removed, more space for people and a place to dwell

Slow traffic environment improving the setting of St Matthew's Church

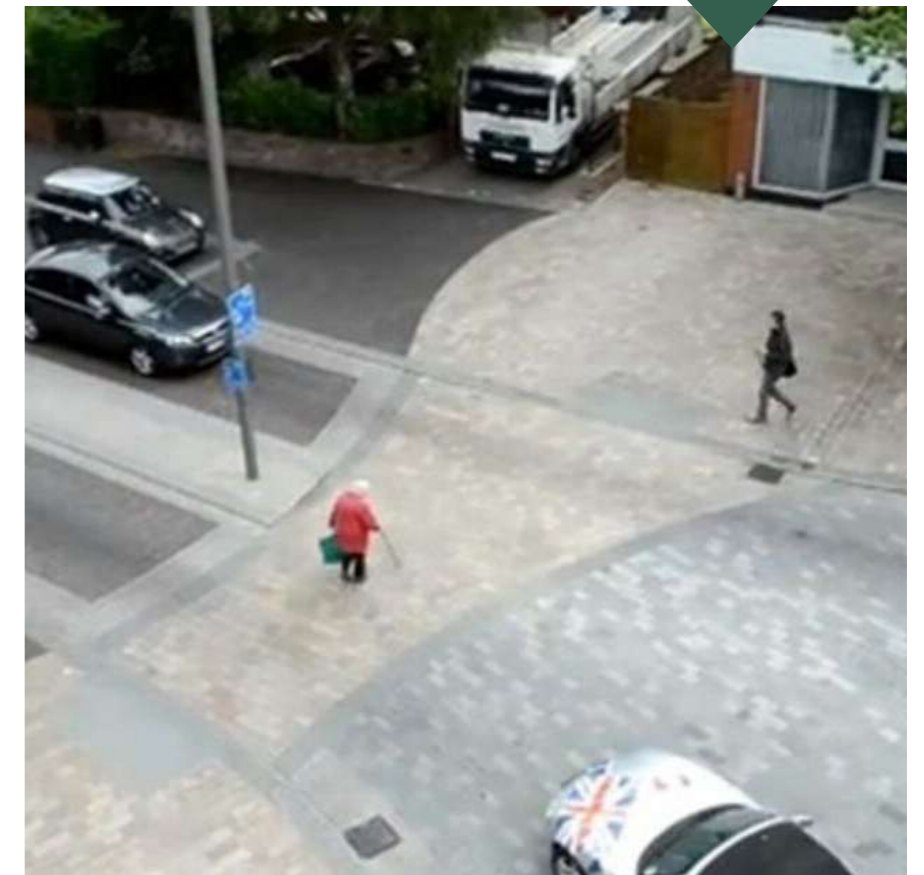



# 5.3 Holbeck Centre and Top Moor Side

## Materials, planting and furniture



High quality materials used in setting of listed St Matthews

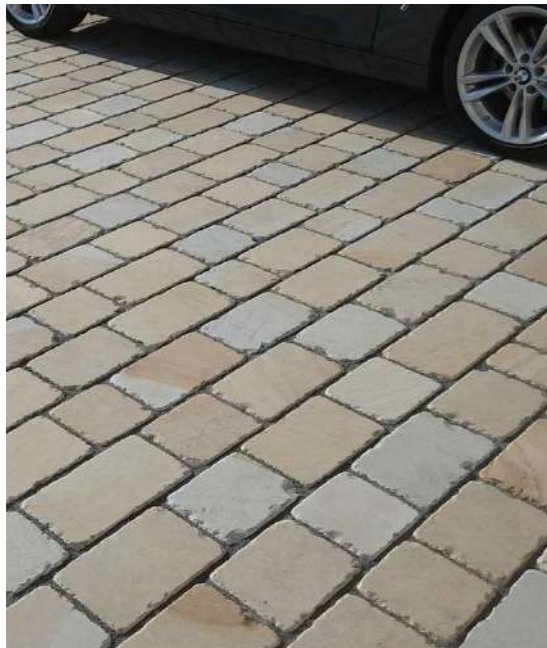

Rain garden planting



Rain garden planting

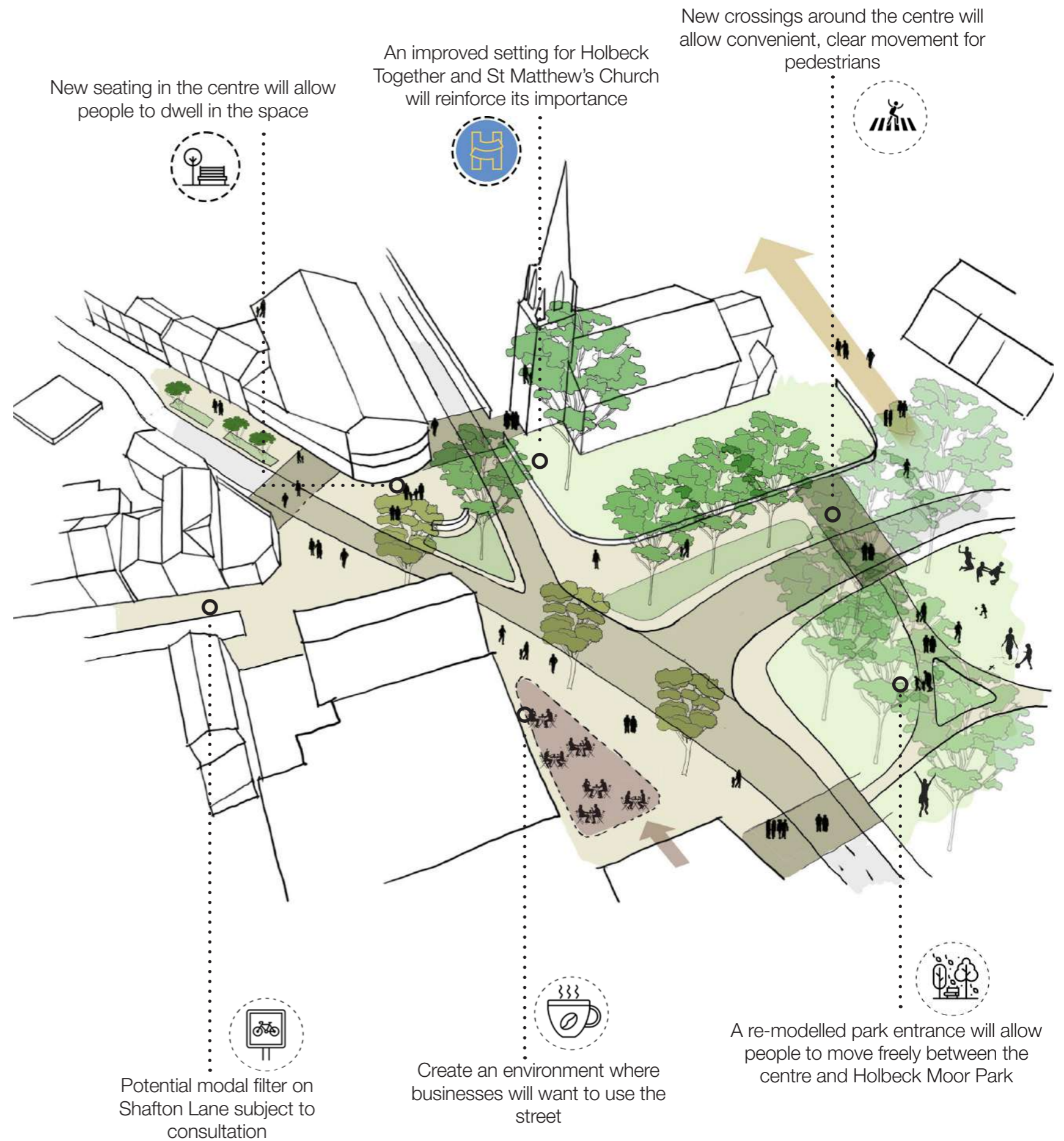

## 5.4 Holbeck Moor Park

- An inclusive, safe and multi-functional space for the whole community
- Existing, well-used assets will be supplemented with more facilities for a wider group of people, within a more cohesive network of parks and spaces
- The park will have a strong, direct relationship with St Matthew's Community Centre, by downgrading Domestic Street and creating a new access in from Holbeck Centre
- Spaces within the park will be open and inviting, allowing people to participate actively and passively in different activities
- New access points will provide direct routes in to the park for more people, all linked by a new perimeter exercise loop for walking, running and wheeling
- Better routes through will contribute to the park being a safer experience for more people, so no one feels excluded

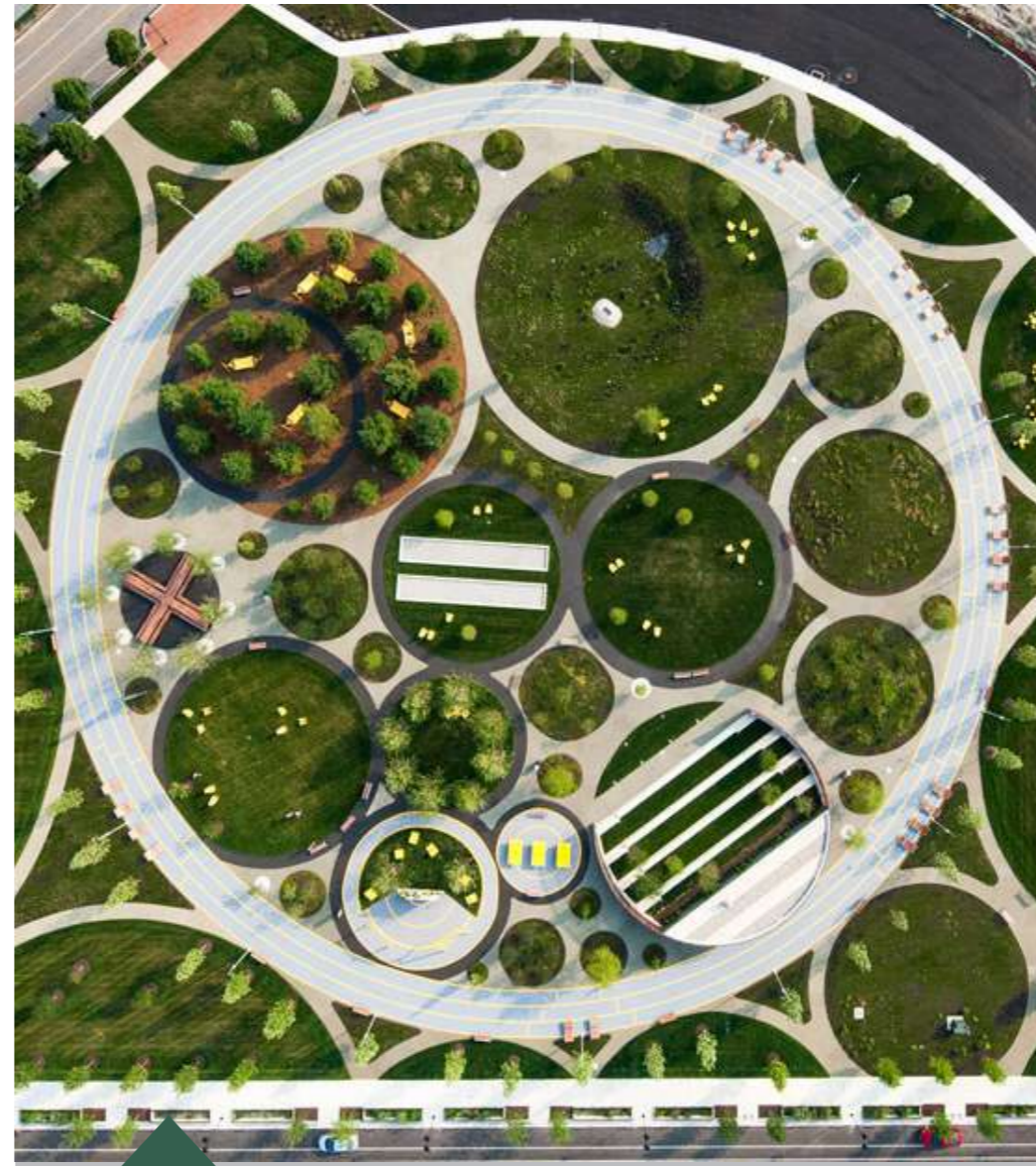

The park will have a framework of paths that give people multiple options to access the space, facilities will be open and integrated into the park with passive seating spaces

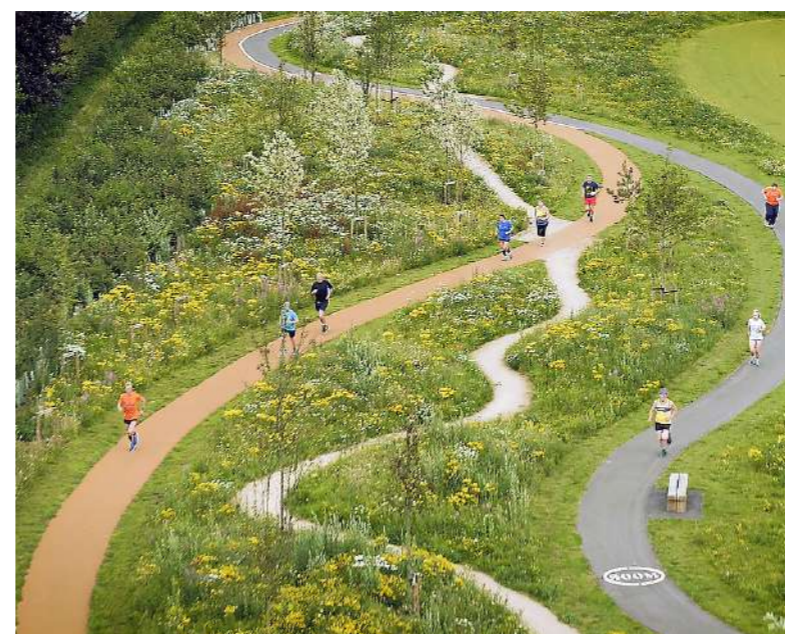

A perimeter multi-use exercise loop

# 5.4 Holbeck Moor Park

## Materials, planting and furniture



Inclusive play for people of all ages with multiple functions



Different bound and unbound gravel



Curved paths and open lawns

An improved skate park can be designed to meet the needs of all potential users, encouraging passive interaction



Meadow planting could increase biodiversity, reduce maintenance and frame a new exercise track



The active track could provide an informal exercise loop for people of all ages, walking or wheeling



A new playful environment could encourage wider interaction and inventive play

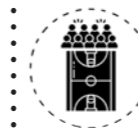

The MUGA has the potential to integrate better with the park, allowing people to move freely in and out, while providing space for informal spectators

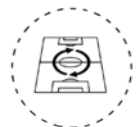

Work could be undertaken to improve facilities for sports on Holbeck Moor Park while ensuring there is sufficient space for all users

## 5.4 Holbeck Moor Park

- The Safer Parks guidance was produced by WYCA, based on research by University of Leeds in collaboration with the charity, Making Space for Girls
- It highlights issues that prevent women and girls from using parks such as safety and providing adequate facilities
- Staples of most parks such as MUGA's, skate parks and play areas, all of which are part of Holbeck Moor Park aren't used as much by girls and can create threatening environments for them
- The document provides design guidance on how to design through the eyes of women and girls, to create parks that are designed for more people, more of the time
- It will be important to understand how people use the park at the moment, but most importantly, speak to people who don't use the park at the moment and find out why
- The subject of the skate park is a fantastic opportunity to engage with young people, and potentially the local skate community, to design the right environment for women and girls who want to skate

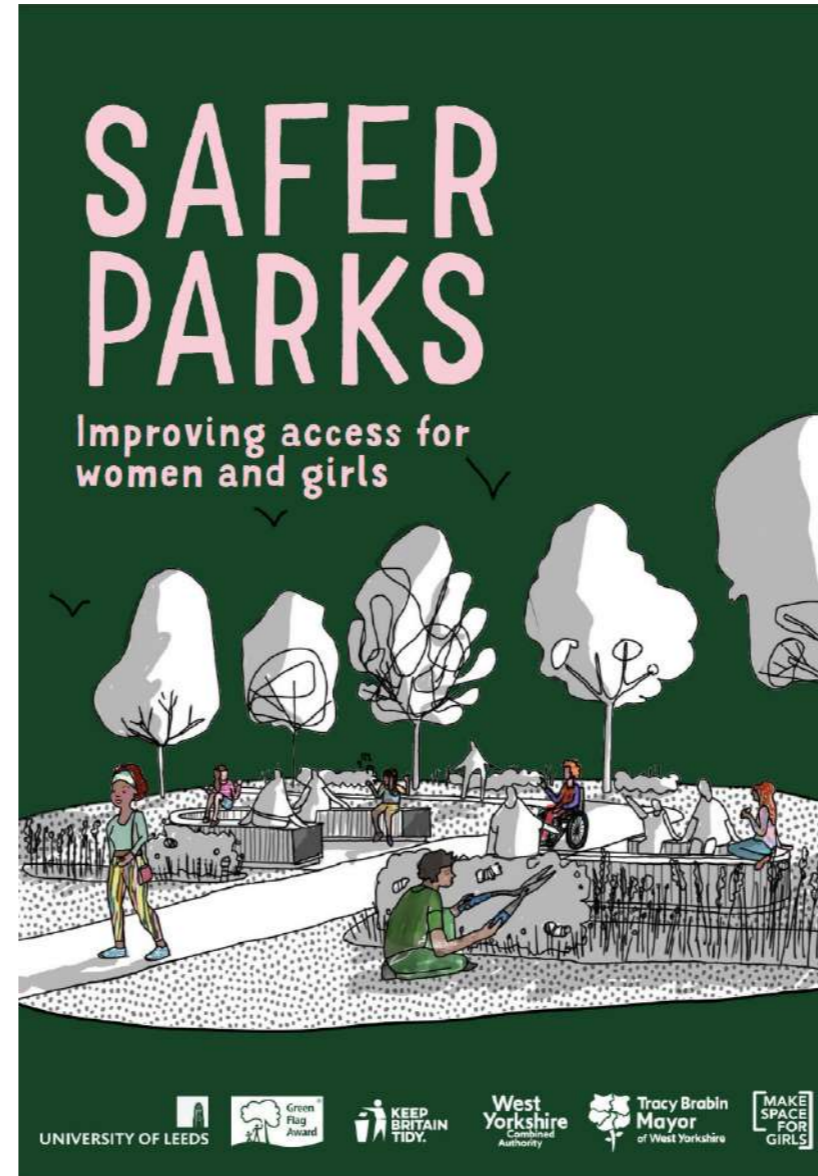

Safer Parks is an invaluable guidance when designing spaces such as Holbeck Moor Park

**Eyes on the Park** reflects that the presence of others makes women and girls feel safer.

**Awareness** addresses design issues that can help women and girls feel more secure.

**Inclusion** considers the importance of bringing a diverse cross-section of women and girls into our parks and designing spaces with their input.

The document is based around three key principles - Eyes on the Park, Awareness and Inclusion

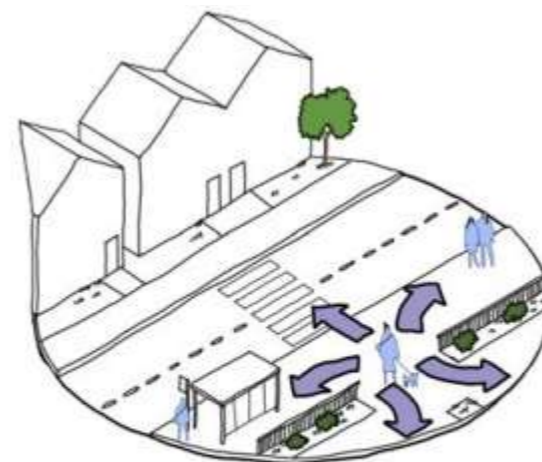

The entrances to a park should be wide and clearly visible.

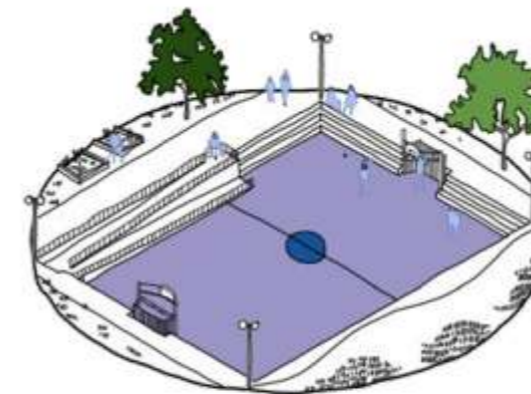

Fenced areas feel very unsafe to teenage girls so other design approaches are more inclusive.

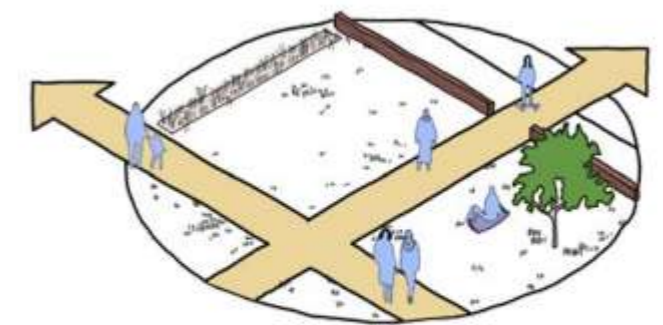

A choice of routes and exits improves the feeling of safety.

The ideas discussed on the previous two pages start to address some of the guidance in the document, to create a safer, more inclusive environment for women and girls

## 5.5 Brown Lane East

- With the public realm improvements over the Inner Ring Road and the ambition to create a sports hub on the Matthew Murray site, Brown Lane East becomes an important east, west movement corridor for people and bikes
- The recent healthy streets programme has also set the tone for a more attractive, safer and more legible, walking route along the street - there is potential to consider an alternative vehicle movement strategy, resulting in one way movement on Brown Lane East.
- This would allow to continuation of the recently built section of cycleway, wider, footpaths and extension of the tree, planting towards Holbeck Moor Park This route would form part of an alternative slower route through Holbeck as well, as providing a safer route for children to go to school.
- There is an opportunity to work with residents to maximise the benefits of recent healthy streets work and ensure they are reap the benefits of new pocket green spaces



Protected cycle route, with wider footpath and street trees - modal filter to west of the street



Possible one way vehicle route, with some parking retained

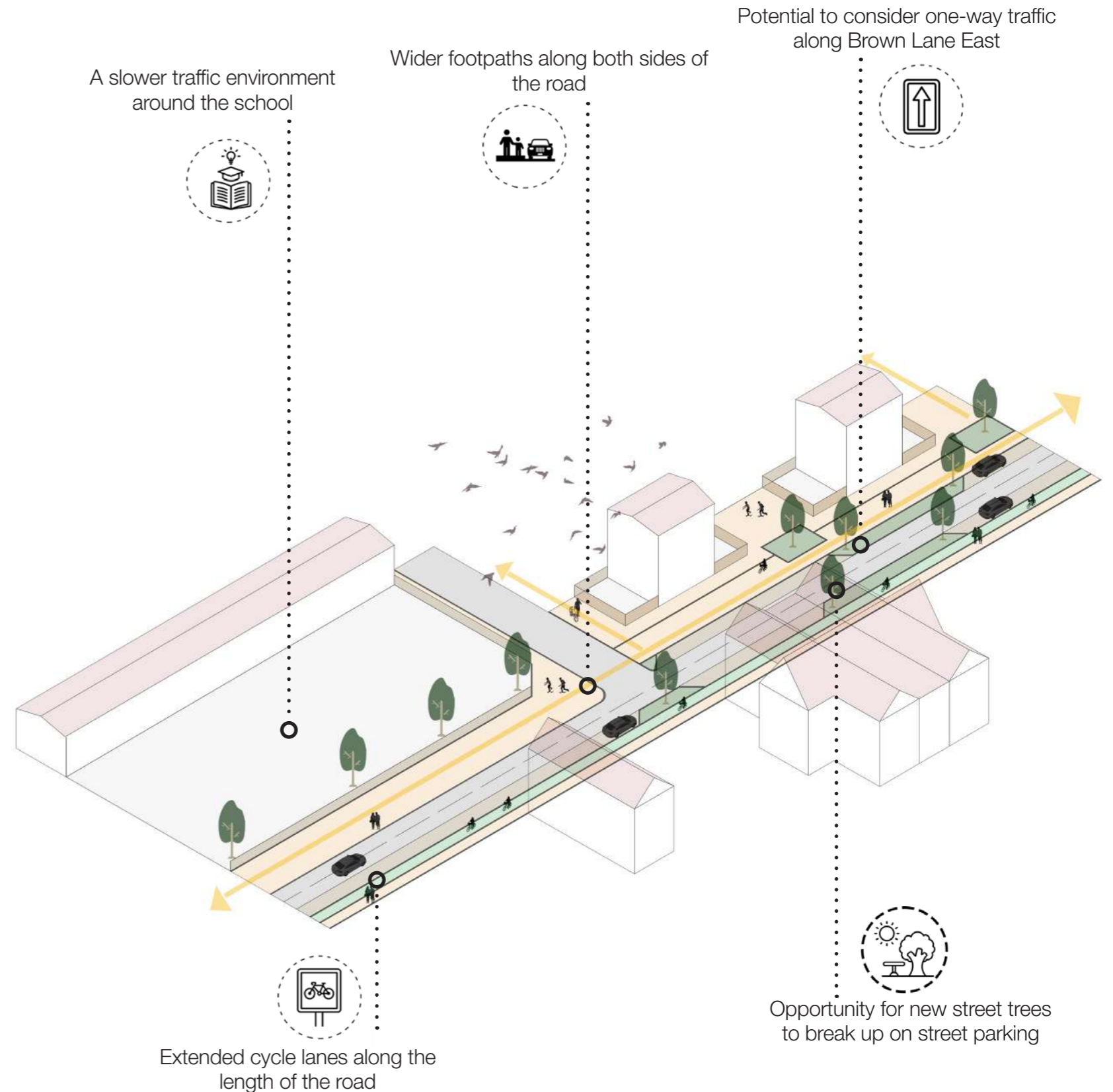

## 5.6 St Matthew's Park

- There is an opportunity to work with local people and the PFI contractor to discuss the future of the space around the Church Yard and the swathe of green space along Nineveh Road
- There is potential to create a park space that will have its own distinct identity, characterised by the site's heritage
- There is an opportunity to supplement some of the uses in Holbeck Moor Park to provide door step play and community space
- A comprehensive sustainable drainage system could take run-off from surrounding streets while providing new habitats throughout the park
- The park will provide a legible, well signed active travel route linking Holbeck Centre with Bridge Road and the city centre
- Improvements to access, sight lines and maintenance can make the space be more visible and feel safer



Smaller, explorative play, located close to homes and within a more natural environment



The park will be a valuable wildlife, drainage and active travel corridor that connects Holbeck with the city centre



## 5.7 Pocket Parks

- While Holbeck Moor Park is a fantastic asset for the community, there is also the opportunity to improve existing spaces closer to people's front door.
- Existing pocket spaces around the community have the potential to improve in the future to offer better quality 'door step' amenity for residents
- Working with residents, the spaces can be shaped to meet the needs of those living close by, whether that be somewhere to play, somewhere to grow food, and/or somewhere to meet and socialise with their neighbours



A series of projects, led by immediate residents for each space, explored through participatory workshops



A place to play? with different habitats? or grow food?

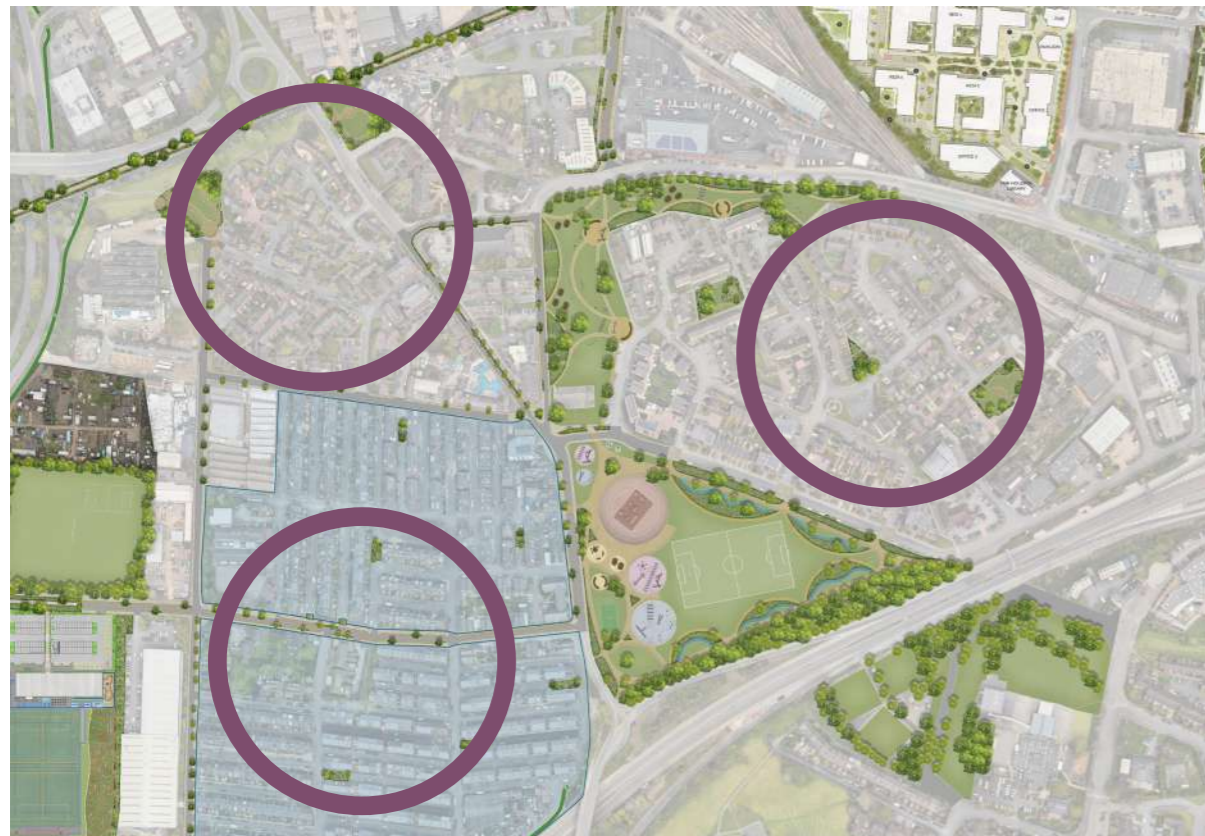

# 5.8 Stocks Hill and Bridge Road

- Bridge Road, identified as a Local Green Corridor can be changed to an safe and attractive walking and cycling route
- The route would connect with streetscape improvements and current developments on Sweet Street and become the missing piece to connect with South Bank
- A redeveloped street would create a high quality setting for new development and allow alternative uses of the arches to be explored

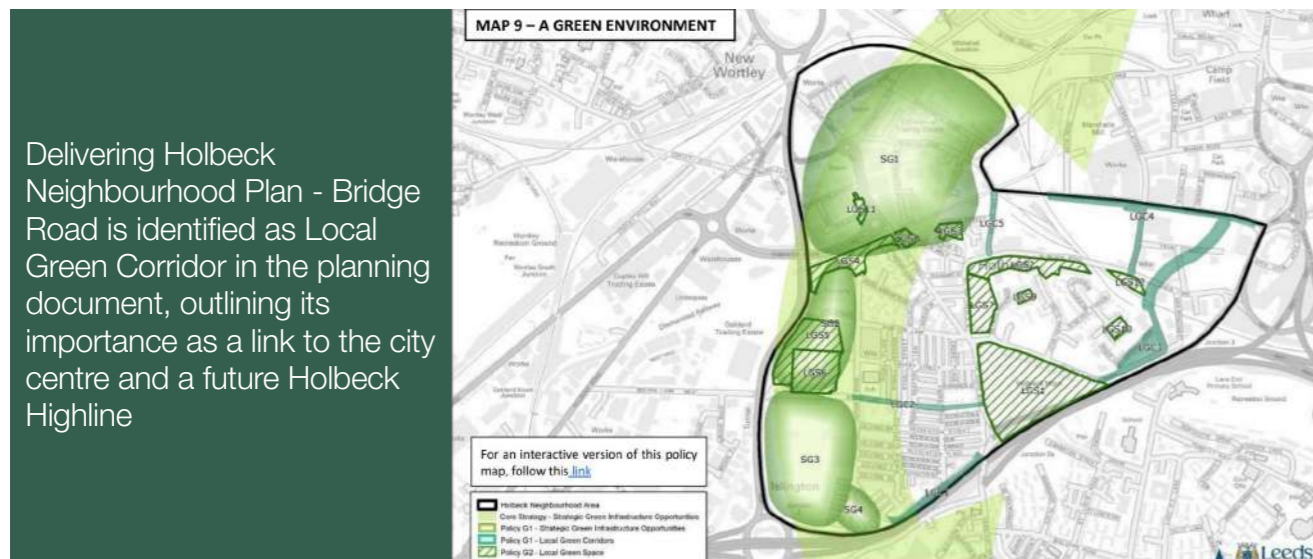

Delivering Holbeck Neighbourhood Plan - Bridge Road is identified as Local Green Corridor in the planning document, outlining its importance as a link to the city centre and a future Holbeck Highline



A remodelled streetscape will provide an important link to Water Lane



Currently an unattractive rat run for vehicles and an illegible route into the city

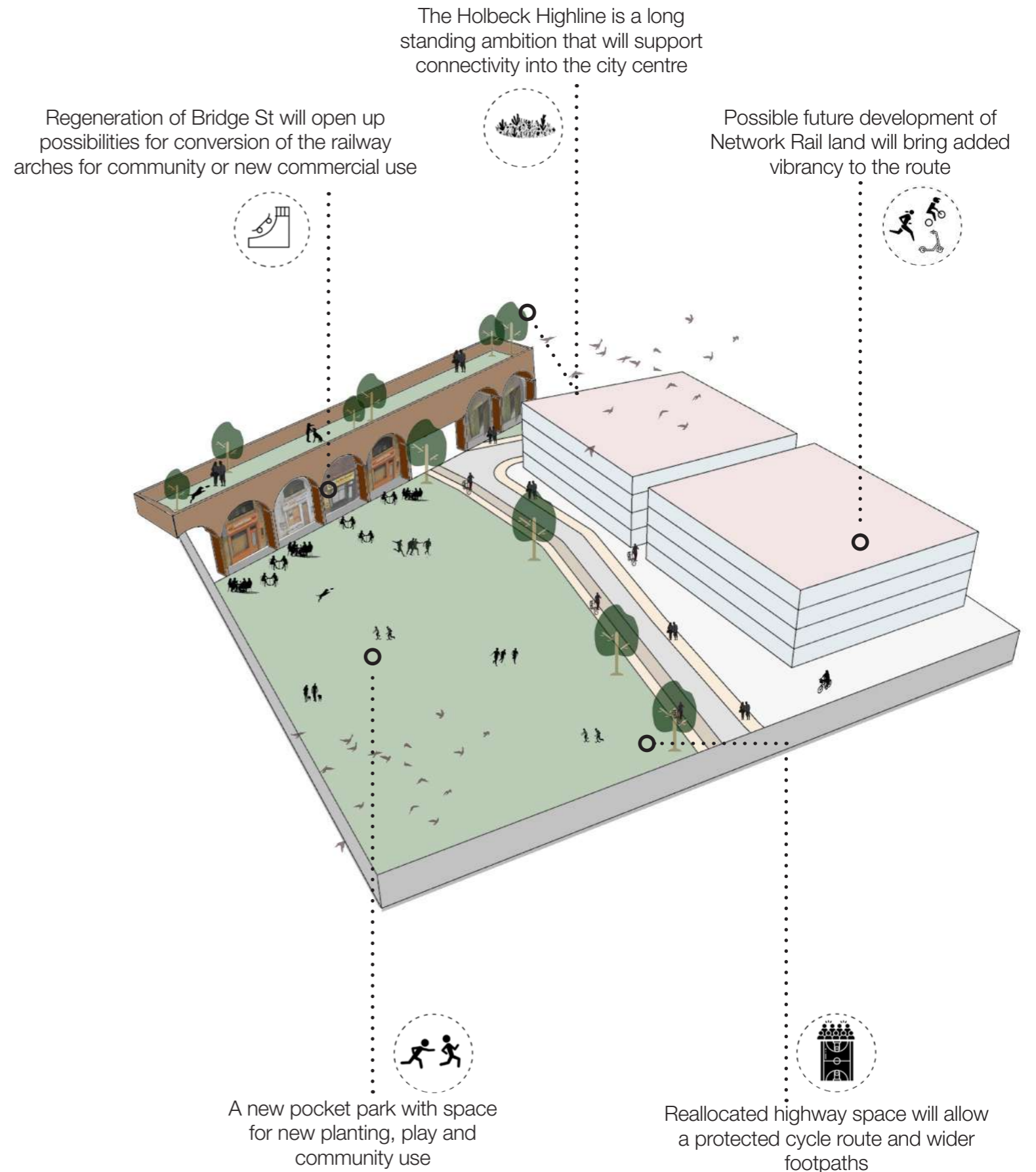



## 5.9 Receptions Group Repair

- Phase 3 of the Holbeck Group Repair retrofit scheme
- Will include external wall insulation process to meet the PAS2035 specification
- Measures will ensure there are no cold spots to the insulation, and include work around as window/door openings and at eaves level of the roof minimum below DPC level etc.



Phase 3 of the group repair scheme will provide more efficient and comfortable housing for local people

### HC3 - Holbeck Housing Heritage Area

- Most of Character Area 5, described in Section 14 – Heritage Assets, consists of Type II and Type III back-to-backs and terrace housing constructed in the late 19<sup>th</sup> and early 20<sup>th</sup> century for workers in the mills and factories in the area. These are a significant part of the heritage of Holbeck and are a legacy of how the pre-industrial village grew to serve the expanding businesses which played a key role in Leeds' success as an industrial city in that period.
- The area is need of improvement and regeneration, both the individual houses within it and the spaces, streets and yards between them. However, that regeneration should not be at the expense of the character of this area which is an important part of its historic significance.



Holbeck Housing Heritage Area, looking west  
(Imagery and Map data © 2017 Google).

### Policy HC3 – Holbeck Housing Heritage Area

Development within the Holbeck Housing Heritage Area (as defined on the Policies Maps 4 and 11) should respect the historic, archaeological and architectural character of the area and buildings and structures within it, including but not exclusively, positive characteristics which give the area its distinctive identity, such as:

- the linear and regular form of the terraces;
- scale of the houses;
- materials and window/door details;
- roofscapes including chimneys.

Proposals for development within the Holbeck Historic Core should demonstrate:

- an understanding of the historic significance of the site, and;
- how the development will seek to respect its heritage attributes in ways which will be particularly beneficial to the future of Holbeck.



A large area of the Receptions is identified as the Holbeck Housing Heritage Area in the HNP and states that regeneration should not be at the expense of the character of this area

# NEXT STEPS

## 6.0 Next Steps

This plan builds on the identified projects in the LUF bid to create a longer term framework for the regeneration of Holbeck Streets and Spaces. The LUF funding must be invested by March 2026, therefore a number of steps need to be taken to ensure the projects are delivered on time. At the same time, the scope and budget of other regeneration projects need to be explored, alongside potential funding routes.

- Engage with local councillors, community stakeholders and residents on the;
  - + Outline proposals for the LUF funded projects
  - + Scope and ambition of future projects, ensuring that current funding position is understood
  - + Other projects that they would like to prioritise
- Review additional projects that could be delivered within LUF money
- Identify other funding streams that could broaden the scope of the project
- Develop proposals for LUF funded projects, to engage with a contractor and firm up budgets
- Re-engage with community on final proposals
- Prepare spatial framework for fast developing area within the HNP, north of Bridge Street that identifies public realm initiatives and helps guide S106 money to Holbeck's regeneration



Active engagement with residents



Develop proposals for both Holbeck Moor Park and Domestic Street with community input

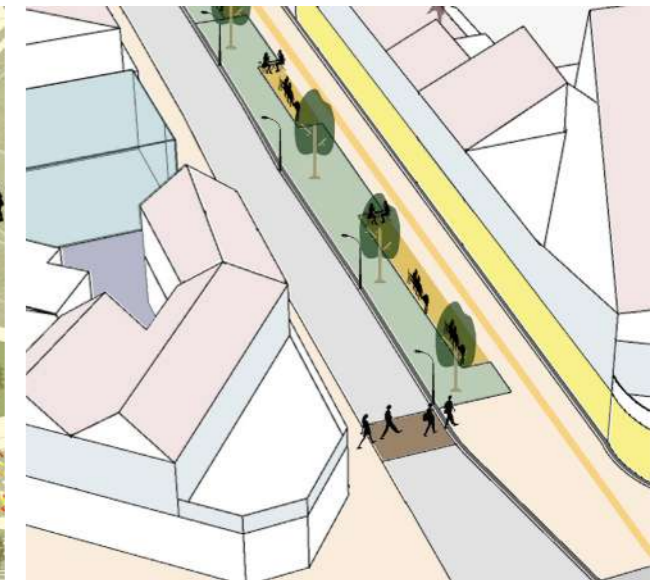

Leeds Studio  
Department, Leeds Dock,  
4 The Boulevard,  
Leeds, LS10 1PZ  
0113 245 4695

Manchester Studio  
Beehive Mill,  
Jersey Street,  
Manchester, M4 6JG  
0161 397 4953

Edinburgh Studio  
5 Rose Street,  
Edinburgh,  
EH2 2PR  
0131 354 1876

[re-formlandscape.com](http://re-formlandscape.com)

# **PIONEERING ENDURING ENVIRONMENTS**

# Appendix A - Schedule of Projects

Project funded through LUF
  Potential future project to be developed with the community

Project	Description	Key considerations	Budget range
Domestic St and St Matthew's St	<ul style="list-style-type: none"> <li>One-way vehicle movement, unlocking space along main local street</li> <li>Wider footpaths, new street trees with more space and a better setting for retailers</li> </ul>	<ul style="list-style-type: none"> <li>Impact of traffic flows on surrounding highways and potential complimentary projects</li> <li>Engagement with current businesses to understand how public realm can support them</li> <li>Management of planting and whether long term success of rain garden planting is feasible</li> <li>Engaging with landowners to consider long term plans for vacant or underutilised sites</li> <li>Location of parking, disabled parking in particular</li> <li>Utilities and impact on new planting</li> </ul>	£500k +
Holbeck Centre + Top Moor Side	<ul style="list-style-type: none"> <li>The junction will become a space that prioritises people and a clearer, safer environment</li> <li>The refurbishment of St Matthew's Community Centre and extension of the old Box Office will create a substantial community anchor</li> </ul>	<ul style="list-style-type: none"> <li>The impact of removing the roundabout at the junction of Domestic St and Top Moor Side</li> <li>Engagement with Holbeck Together to consider the potential for the southern churchyard and building entrance</li> <li>Location of parking, position on the street and impact on shops and businesses</li> <li>Location and design of pedestrian crossings into the park</li> <li>The highway movement plan for facilitating a modal filter on Shafton Lane</li> </ul>	£100-500k
Holbeck Moor Park	<ul style="list-style-type: none"> <li>Multi-functional local park that will support play, exercise and community events</li> <li>A new framework of paths and access points, creating easier and more inclusive access</li> </ul>	<ul style="list-style-type: none"> <li>The edges and entrances into the park, their position and coordination with pedestrian crossings</li> <li>A programme for the park - what events will be held, how do they operate and what space do they require</li> <li>The long term impact of a potential Mass Transit route in Holbeck - how can short term regeneration be delivered without abortive work</li> <li>The design and layout of sports and play facilities, ensuring that community voices guide the process</li> </ul>	£500k +
Brown Lane East + Ingram Road	<ul style="list-style-type: none"> <li>A re-modelled active travel street that connects Holbeck Moor Park with the Sports Hub</li> <li>Wider footpaths, street trees and protected cycle ways and potential to consider the re-routing of traffic to create a one-way loop around the Recreations</li> </ul>	<ul style="list-style-type: none"> <li>Interface with Holbeck Sports Hub to include a clear, safe cycle and pedestrian route</li> <li>Potential to create an improved entrance to Shafton Lane allotments as part of broader community offer</li> <li>Careful understanding of local car parking and how that can coordinate with wider footpaths and cycleway</li> <li>Location of utilities and impact of changing levels and tree planting</li> <li>A coordinated approach to street tree planting in the highway to ensure long term success of planting</li> <li>Interface with new green space proposed alongside Holbeck Sports Hub off Ingram Road</li> </ul>	£500k +
St Matthew's Park	<ul style="list-style-type: none"> <li>Create a linear park combining the church yard and swathe of green space to the south of Nineveh Road</li> <li>Doorstep facilities for residents and an attractive strategic active travel route</li> </ul>	<ul style="list-style-type: none"> <li>Understand the constraints and location of graves and ledger stones</li> <li>Detailed topographical survey to inform sustainable drainage strategy</li> <li>Car parking locations on Meynell Approach to ensure a clear route can be established through the park (part of Holbeck Heritage Trail)</li> <li>Understanding how local people use the space, and how the space could improve their lives</li> </ul>	£100-500k
Pocket Parks	<ul style="list-style-type: none"> <li>A programme of working with residents to adapt their local spaces and encourage long term stewardship</li> <li>Ideas around play, food growing, new habitats and social space can be explored</li> </ul>	<ul style="list-style-type: none"> <li>Understanding what local people like about their local spaces, their fears and hopes</li> <li>Engagement with the PFI contractor in eastern Holbeck to consider the scope of potential projects</li> <li>Plans for the maintenance of future projects and the potential role of the community</li> <li>Engagement with LCC highways, particularly in the Recreations, to consider impact on parking and access</li> </ul>	£50-100k
Stocks Hill + Bridge Road	<ul style="list-style-type: none"> <li>An important linking street between St Matthew's Park and Water Lane</li> <li>The street will maintain 2-way vehicle movement but with a narrowed carriageway to improve the pedestrian experience</li> </ul>	<ul style="list-style-type: none"> <li>The project is already being implemented</li> </ul>	£100-500k